

N ^o of Courses	Courses of the Creek	Distance
1	N 29 E	67
2	N 63 E	42
3	N 78 E	38
4	N 46 E	16
5	S 33 E	30
6	S 72 E	28
7	N 82 E	37
8	S 42 E	66
Total dist		324

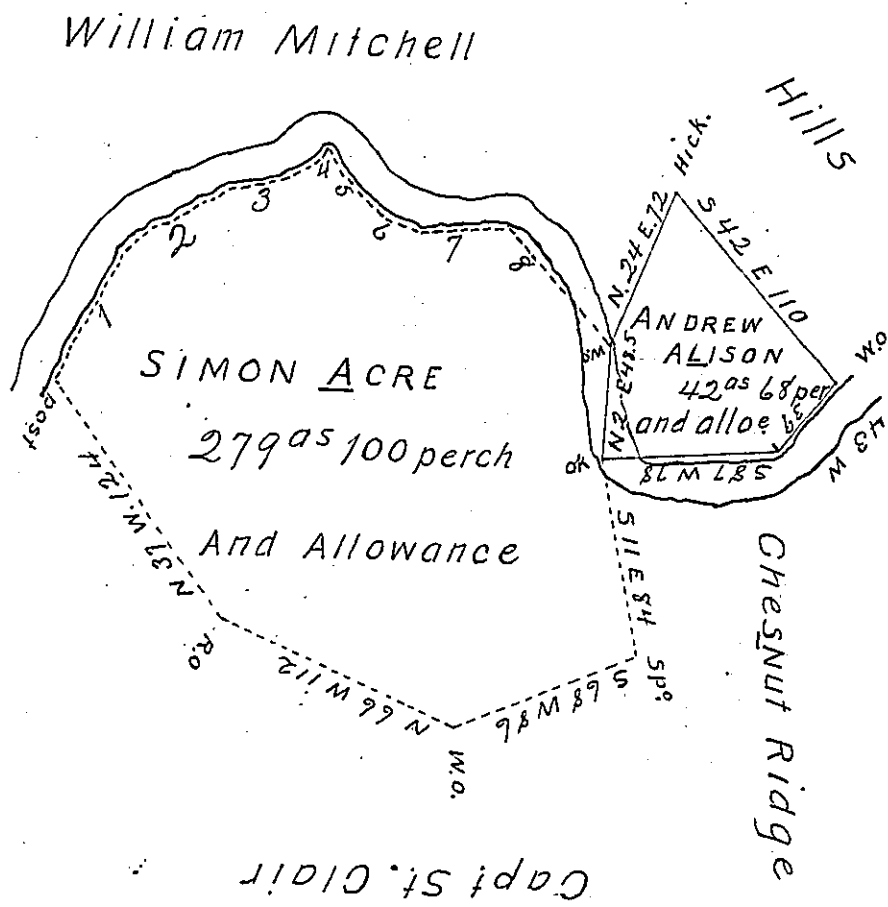

Draught of a part of a tract of land situated on the North west side Loyalhanna Creek in Derry Township Westmoreland County containing Forty-two Acres, and sixty eight perches, and Allowance Surveyed February 1st 1819. It being part of a larger tract Surveyed for Simon Acre October 17th 1769 by Robert McCrea then D. S. In pursuance of an Order dated the 3rd of April 1769. Situated on the South West side of the Loyalhanna Creek in Westmoreland County joining the Chestnut Ridge, and the Shelving Rocks, or otherwise called Pine, or Spruce Rocks. Said to contain two hundred, and seventy-nine Acres, and One hundred perches, and allowance proportioned, at six per Cent (Called the upright Lott)

Jacob Spangler Esqr. J. J. }
of Pennsylvania }

Thomas Potter D. S.

IN TESTIMONY that the above is a copy of the original remaining on file in the Department of Internal Affairs of Pennsylvania, made conformably to an Act of Assembly approved the 16th day of February, 1833, I have hereunto set my Hand and caused the Seal of said Department to be affixed at Harrisburg, this first day of September 1903

Grace B. Brown
Secretary of Internal Affairs.